

Gear Couplings

RINGFEDER®

TNZ ZCAUU / TNZ ZCBUU

Extended universal hubs

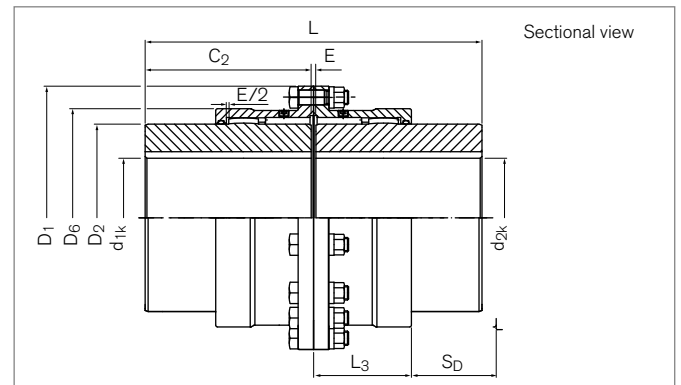
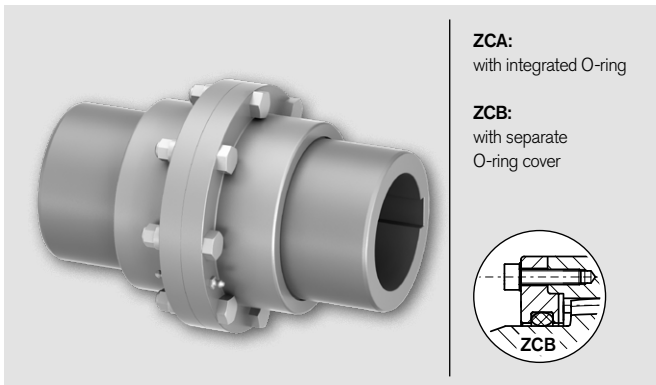

| Identifier | | Size | T_{KN} | T_{Kmax} | n_{max} | d_{1k} min-max | d_{2k} min-max | D_1 | D_2 | D_6 | C_2 |
|------------|--------|------|----------|------------|-----------|---------------------|---------------------|-------|-------|-------|-------|
| ZCAUU | ZCBUU | | Nm | Nm | 1/min | mm | mm | mm | mm | mm | mm |
| XC2306 | --- | 69 | 1750 | 3500 | 6000 | 12 - 50 | 12 - 50 | 111 | 69 | 81,5 | 105 |
| XC2308 | --- | 85 | 2750 | 5500 | 4600 | 18 - 60 | 18 - 60 | 152 | 85 | 103,5 | 115 |
| XC2310 | XC3310 | 107 | 5500 | 11000 | 4200 | 28 - 75 | 28 - 75 | 178 | 107 | 127,5 | 130 |
| XC2313 | XC3313 | 133 | 8500 | 17000 | 4000 | 40 - 95 | 40 - 95 | 213 | 133 | 156 | 150 |
| XC2315 | XC3315 | 152 | 13500 | 27000 | 3850 | 50 - 110 | 50 - 110 | 240 | 152 | 181 | 170 |
| XC2317 | XC3317 | 179 | 22000 | 44000 | 3700 | 60 - 130 | 60 - 130 | 280 | 179 | 209 | 185 |
| XC2320 | XC3320 | 209 | 35000 | 70000 | 3200 | 70 - 155 | 70 - 155 | 318 | 209 | 245,5 | 215 |
| XC2323 | XC3323 | 234 | 43000 | 86000 | 2900 | 85 - 170 | 85 - 170 | 346 | 234 | 274 | 245 |
| XC2325 | XC3325 | 254 | 68000 | 136000 | 2600 | 95 - 190 | 95 - 190 | 389 | 254 | 307 | 295 |
| XC2327 | XC3327 | 279 | 82000 | 164000 | 2300 | 110 - 210 | 110 - 210 | 425 | 279 | 334,5 | 300 |
| XC2330 | XC3330 | 305 | 150000 | 300000 | 2100 | 120 - 230 | 120 - 230 | 457 | 305 | 366 | 305 |
| XC2335 | XC3335 | 355 | 195000 | 390000 | 1800 | 130 - 270 | 130 - 270 | 527 | 355 | 423 | 310 |

To continue see next page

Gear Couplings RINGFEDER® TNZ ZCAUU / TNZ ZCBUU

| Identifier | | Size | E | L | L ₃ | S _D | ΔK _r | ΔK _w | J | V _{GR} | G _{Wsb} |
|------------|--------|------|----|-----|----------------|----------------|-----------------|-----------------|-----------------------------------|-----------------|------------------|
| ZCAUU | ZCBUU | | mm | mm | mm | mm | mm | | 10 ⁻³ kgm ² | dm ³ | kg |
| XC2306 | --- | 69 | 3 | 213 | 39 | 80 | 0,42 | 2 x 0,5 | 6 | 0,07 | 7,5 |
| XC2308 | --- | 85 | 3 | 233 | 46 | 83 | 0,51 | 2 x 0,5 | 23 | 0,08 | 14,0 |
| XC2310 | XC3310 | 107 | 3 | 263 | 59 | 85 | 0,66 | 2 x 0,5 | 54 | 0,13 | 23,1 |
| XC2313 | XC3313 | 133 | 5 | 305 | 69 | 100 | 0,77 | 2 x 0,5 | 137 | 0,22 | 39,8 |
| XC2315 | XC3315 | 152 | 5 | 345 | 83 | 106 | 0,99 | 2 x 0,5 | 252 | 0,38 | 57,1 |
| XC2317 | XC3317 | 179 | 6 | 376 | 93 | 115 | 1,15 | 2 x 0,5 | 530 | 0,58 | 86,0 |
| XC2320 | XC3320 | 209 | 6 | 436 | 106 | 132 | 1,33 | 2 x 0,5 | 1077 | 0,75 | 133,1 |
| XC2323 | XC3323 | 234 | 8 | 498 | 118 | 151 | 1,5 | 2 x 0,5 | 1748 | 1,25 | 179,1 |
| XC2325 | XC3325 | 254 | 8 | 598 | 138 | 181 | 1,75 | 2 x 0,5 | 3283 | 1,92 | 263,7 |
| XC2327 | XC3327 | 279 | 8 | 608 | 154 | 185 | 1,99 | 2 x 0,5 | 4780 | 2,67 | 318,1 |
| XC2330 | XC3330 | 305 | 8 | 618 | 166 | 178 | 2,13 | 2 x 0,5 | 6329 | 3,33 | 374,4 |
| XC2335 | XC3335 | 355 | 10 | 630 | 193 | 174 | 2,55 | 2 x 0,5 | 12186 | 5 | 531,4 |

- Examine the load capacity of the shaft-hub connection
- Hubs pilot bored, bore diameter 2 mm smaller than smallest finish bore diameter

Explanation

| | | | | | |
|---|--|----------------------|--|------------------------|---|
| T_{KN} | = Nom. Transmissible torque | D₁ | = Outer diameter | L₃ | = Length |
| T_{Kmax} | = Max. transmissible torque of the coupling | D₂ | = Outer diameter hub | S_D | = Disassembly Space |
| n_{max} | = Max. rotation speed | D₆ | = Diameter | ΔK_r | = Max. permissible radial misalignment |
| d_{1kmin}; d_{2kmin} | = Min. bore diameter d ₁ /d ₂ with keyway acc. to DIN 6885-1 | C₂ | = Guided length in hub bore | ΔK_w | = Max. permissible angular misalignment |
| d_{1kmax}; d_{2kmax} | = Max. bore diameter d ₁ /d ₂ with keyway acc. to DIN 6885-1 | E | = Gap width between left and right component | J | = Total moment of inertia |
| | | L | = Total length | V_{GR} | = Grease volume |
| | | | | G_{Wsb} | = Weight at smallest bore diameter |

Ordering example

| Identifier | Size | d _{1k} | d _{2k} | Further details |
|------------|------|-----------------|-----------------|-----------------|
| XC2325 | 254 | 150 | 180 | * |

^{*)} Without any other specification, we deliver as a standard: keyway acc. to DIN 6885-1, keyway side fit P9, bore tolerance H7; optional with set screw

Further information on
RINGFEDER® TNZ ZCAUU / TNZ ZCBUU

DISTRIBUTED BY



chainanddrives.com.au
support@chainanddrives.com.au

Disclaimer of liability

All technical details and notes are non-binding and cannot be used as a basis for legal claims. The user is obligated to determine whether the represented products meet his requirements. We reserve the right carry out modifications at any time in the interests of technical progress.

