

# 3020 A

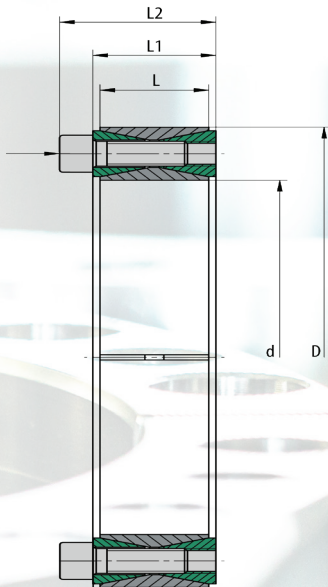

## Used symbols

$d$	[mm]	Shaft diameter
$D$	[mm]	Hub inside diameter
$M_t$	[Nm]	Max. transmittable torque $F_{ax} = 0$
$F_{ax}$	[kN]	Max. transmittable axial force $M_t = 0$
$p_w$	[N/mm <sup>2</sup> ]	Average pressure on the shaft
$p_N$	[N/mm <sup>2</sup> ]	Average pressure on the hub
$L$	[mm]	Length of the sleeve inside and outside
$L_1$	[mm]	Width of the locking device without screws
$L_2$	[mm]	Width of the locking device with screws
$Z$		Number of clamping screws
$S$		Size of the clamping screws
$M_A$	[Nm]	Tightening torque of the clamping screws

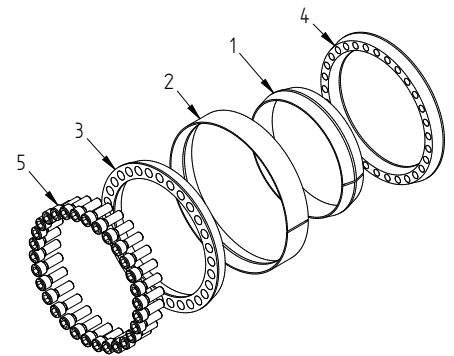

## Recommended tolerances & surfaces

Shaft	from h11 to k11 / Rz10
Hub	from H11 to N11 / Rz10

## Bending loads

Bending moment (share)	depending on hub
Bending angle	max. 2°

## More properties

- no axial displacement during assembly
- no self-centering
- no self-locking

Pos.	Designation
1	Sleeve
2	Outer ring
3	Pressure ring 1
4	Pressure ring 2
5	Screw

Ordering information: TAS 3020/d/D A (e.g: TAS 3020A/150/200 A ... further sizes on request)

# 3020 A

<b>d</b> mm	<b>D</b> mm	<b>M<sub>t</sub></b> Nm	<b>F<sub>ax</sub></b> kN	<b>P<sub>w</sub></b> N/mm <sup>2</sup>	<b>P<sub>N</sub></b> N/mm <sup>2</sup>	<b>Z</b> Pcs.	<b>S</b>	<b>M<sub>A</sub></b> Nm	<b>L</b> mm	<b>L<sub>1</sub></b> mm	<b>L<sub>2</sub></b> mm	<b>Weight</b> kg
20	x 47	258	26	203	86	8	M6 x 018	14	17	20	27,5	0,23
22	x 47	284	26	185	86	8	M6 x 018	14	17	20	27,5	0,23
24	x 50	349	29	170	82	9	M6 x 018	14	17	20	27,5	0,26
25	x 50	363	29	163	82	9	M6 x 018	14	17	20	27,5	0,25
28	x 55	452	32	218	111	10	M6 x 018	14	17	20	27,5	0,30
30	x 55	484	32	203	111	10	M6 x 018	14	17	20	27,5	0,29
32	x 60	619	39	191	102	12	M6 x 018	14	17	20	27,5	0,32
35	x 60	677	39	175	102	12	M6 x 018	14	17	20	27,5	0,32
38	x 65	973	51	228	133	14	M6 x 018	14	17	20	27,5	0,34
40	x 65	903	45	191	118	14	M6 x 018	14	17	20	27,5	0,34
42	x 75	1485	71	237	133	12	M8 x 022	35	20	24	33,5	0,57
45	x 75	1591	71	221	133	12	M8 x 022	35	20	24	33,5	0,57
48	x 80	1697	71	207	125	12	M8 x 022	35	20	24	33,5	0,60
50	x 80	1768	71	199	125	12	M8 x 022	35	20	24	33,5	0,60
55	x 85	2269	83	226	147	14	M8 x 022	35	20	24	33,5	0,63
60	x 90	2476	83	207	138	14	M8 x 022	35	20	24	33,5	0,69
65	x 95	3062	94	191	131	16	M8 x 022	35	20	24	33,5	0,73
70	x 110	4508	129	241	153	14	M10 x 025	70	24	28	39,5	1,26
75	x 115	4830	129	225	147	14	M10 x 025	70	24	28	39,5	1,33
80	x 120	5151	129	211	141	14	M10 x 025	70	24	28	39,5	1,40
85	x 125	6255	148	199	135	16	M10 x 025	70	24	28	39,5	1,49
90	x 130	6624	148	188	130	16	M10 x 025	70	24	28	39,5	1,53
95	x 135	7865	165	213	150	18	M10 x 025	70	24	28	39,5	1,62
100	x 145	9795	196	235	163	14	M12 x 030	125	26	33	47	2,01
110	x 155	10774	196	214	152	14	M12 x 030	125	26	33	47	2,15
120	x 165	13429	224	209	153	16	M12 x 030	125	26	33	47	2,35
130	x 180	18185	280	184	134	20	M12 x 035	125	34	38	52	3,51
140	x 190	21546	308	189	139	22	M12 x 035	125	34	38	52	3,85
150	x 200	25187	336	192	144	24	M12 x 035	125	34	38	52	4,07
160	x 210	29100	364	195	149	26	M12 x 035	125	34	38	52	4,03
170	x 225	32616	384	179	135	22	M14 x 040	190	38	44	60	5,78
180	x 235	37675	419	184	141	24	M14 x 040	190	38	44	60	6,05
190	x 250	46396	488	169	128	28	M14 x 045	190	46	52	68	8,25
200	x 260	52326	523	171	131	30	M14 x 045	190	46	52	68	8,65
220	x 285	68108	619	171	132	26	M16 x 050	295	50	56	74	11,22
240	x 305	85726	715	181	143	30	M16 x 050	295	50	56	74	12,20
260	x 325	105260	809	189	152	34	M16 x 050	295	50	56	74	13,20
280	x 355	131386	939	169	133	32	M18 x 060	405	60	66	86,5	19,20
300	x 375	158370	1056	177	141	36	M18 x 060	405	60	66	86,5	20,50
320	x 405	222004	1388	179	141	36	M20 x 070	580	72	78	100,5	29,60

# 3020 A

<i>d</i> mm		<i>D</i> mm	<i>M<sub>t</sub></i> Nm	<i>F<sub>ax</sub></i> kN	<i>P<sub>w</sub></i> N/mm <sup>2</sup>	<i>P<sub>N</sub></i> N/mm <sup>2</sup>	<i>Z</i> Pcs.	<i>S</i>	<i>M<sub>A</sub></i> Nm	<i>L</i> mm	<i>L<sub>1</sub></i> mm	<i>L<sub>2</sub></i> mm	Weight kg
340	x	425	235878	1388	168	134	36	M20 x 070	580	72	78	100,5	31,1
360	x	455	304503	1692	169	134	36	M22 x 080	780	84	90	116	42,2
380	x	475	321420	1692	160	128	36	M22 x 080	780	84	90	116	44,0
400	x	495	338337	1692	153	123	36	M22 x 080	780	84	90	116	46,0
420	x	515	450387	2146	161	132	40	M22 x 080	780	84	90	116	46,0
440	x	545	548333	2493	157	127	40	M24 x 090	1000	96	102	127	61,2
460	x	565	573333	2493	150	122	40	M24 x 090	1000	96	102	130	63,7
480	x	585	627500	2618	151	123	42	M24 x 090	1000	96	102	130	66,2
500	x	605	685000	2743	152	125	44	M24 x 090	1000	96	102	130	68,7



[chainanddrives.com.au](http://chainanddrives.com.au)  
[support@chainanddrives.com.au](mailto:support@chainanddrives.com.au)