

NEW RANGE

T5 & T10 TIMING PULLEYS

Aluminium Construction with a Pilot Bore

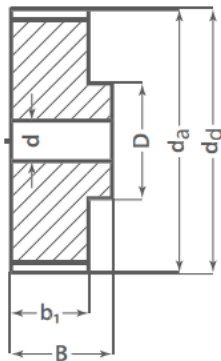

Type 6

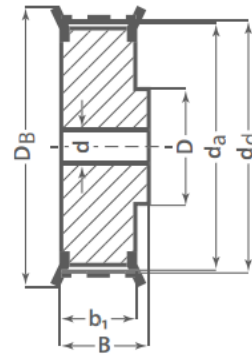

Type 6F

Part No.	Type	Material	No. of teeth	d(d)	d(a)	D(B)	b(1)	B (mm)	D (mm)	Pilot Bore d (mm)	Finished Bore hole (max)	Approx Kg
21-T5-10PB	6F	AL	10	15.92	15.05	19.5	15	21	8	-	5	0.012
21-T5-12PB	6F	AL	12	19.01	18.25	23	15	21	10	-	6	0.016
21-T5-14PB	6F	AL	14	22.29	21.45	25	15	21	13	-	8	0.019
21-T5-15PB	6F	AL	15	23.88	23.05	28	15	21	16	6	10	0.021
21-T5-16PB	6F	AL	16	25.47	24.6	32	15	21	18	6	11	0.025
21-T5-18PB	6F	AL	18	28.65	27.8	32	15	21	19	6	12	0.031
21-T5-19PB	6F	AL	19	30.25	29.4	36	15	21	22	6	12	0.036
21-T5-20PB	6F	AL	20	31.83	31	36	15	21	23	6	14	0.038
21-T5-22PB	6F	AL	22	35.12	34.25	38	15	21	24	6	15	0.046
21-T5-24PB	6F	AL	24	38.21	37.4	42	15	21	26	6	15	0.054
21-T5-25PB	6F	AL	25	39.8	39	44	15	21	26	6	15	0.058
21-T5-26PB	6F	AL	26	41.47	40.6	44	15	21	26	6	16	0.062
21-T5-27PB	6F	AL	27	42.98	42.2	48	15	21	30	8	18	0.064
21-T5-28PB	6F	AL	28	44.62	43.75	48	15	21	32	8	18	0.071
21-T5-30PB	6F	AL	30	47.76	46.95	51	15	21	34	8	18	0.075
21-T5-32PB	6F	AL	32	50.94	50.1	54	15	21	38	8	22	0.088
21-T5-36PB	6F	AL	36	57.31	56.45	63	15	21	38	8	22	0.114
21-T5-40PB	6F	AL	40	63.66	62.85	66	15	21	40	8	23	0.138
21-T5-42PB	6F	AL	42	66.87	66	71	15	21	40	8	24	0.18
21-T5-44PB	6	AL	44	70.07	69.2	-	15	21	45	8	26	0.185
21-T5-48PB	6	AL	48	76.42	75.55	-	15	21	50	8	28	0.2
21-T5-60PB	6	AL	60	95.52	94.65	-	15	21	65	8	35	0.307

WA HEAD OFFICE

Unit 1 / 45 Inspiration Drive WA 6065
 ☎ (08) 9303 4966 📠 (08) 9303 4977
 ✉ info@chainanddrives.com.au

NSW HEAD OFFICE

Unit 7 / 70 Holbeche Road Arndell Park NSW 2148
 ☎ (02) 9674 8611 📠 (02) 9674 8363
 ✉ salesnsw@chainanddrives.com.au

T5 & T10 Metric Timing Pulleys

Part No.	Type	Material	No. of teeth	d(d)	d(a)	D(B)	b(1)	B (mm)	D (mm)	Pilot Bore d (mm)	Finished Bore hole (max)	Approx Kg
27-T5-10PB	6F	AL	10	15.92	15.05	19.5	21	27	8	-	5	0.016
27-T5-12PB	6F	AL	12	19.01	18.25	23	21	27	10	-	6	0.022
27-T5-14PB	6F	AL	14	22.29	21.45	25	21	27	13	-	8	0.026
27-T5-15PB	6F	AL	15	23.88	23.05	28	21	27	16	6	10	0.029
27-T5-16PB	6F	AL	16	25.47	24.6	32	21	27	18	6	11	0.035
27-T5-18PB	6F	AL	18	28.65	27.8	32	21	27	19	6	12	0.043
27-T5-19PB	6F	AL	19	30.25	29.4	36	21	27	22	6	12	0.049
27-T5-20PB	6F	AL	20	31.83	31	36	21	27	23	6	14	0.053
27-T5-22PB	6F	AL	22	35.12	34.25	38	21	27	24	6	15	0.054
27-T5-24PB	6F	AL	24	38.21	37.4	42	21	27	26	6	15	0.076
27-T5-25PB	6F	AL	25	39.8	39	44	21	27	26	6	15	0.081
27-T5-26PB	6F	AL	26	41.47	40.6	44	21	27	26	6	16	0.085
27-T5-27PB	6F	AL	27	42.98	42.2	-	21	27	30	8	18	0.09
27-T5-28PB	6F	AL	28	44.62	43.75	48	21	27	32	8	18	0.092
27-T5-30PB	6F	AL	30	47.76	46.95	51	21	27	34	8	18	0.105
27-T5-32PB	6F	AL	32	50.94	50.1	54	21	27	38	8	22	0.123
27-T5-36PB	6F	AL	36	57.31	56.45	63	21	27	38	8	22	0.16
27-T5-40PB	6F	AL	40	63.66	62.85	66	21	27	40	8	23	0.193
27-T5-42PB	6F	AL	42	66.87	66	71	21	27	40	8	24	0.205
27-T5-44PB	6	AL	44	70.07	69.2	-	21	27	45	8	26	0.228
27-T5-48PB	6	AL	48	76.42	75.55	-	21	27	50	8	28	0.28
27-T5-60PB	6	AL	60	95.52	94.65	-	21	27	65	8	35	0.43
36-T5-10PB	6F	AL	10	15.92	15.05	19.5	30	36	8	-	5	0.023
36-T5-12PB	6F	AL	12	19.01	18.25	23	30	36	10	-	6	0.031
36-T5-14PB	6F	AL	14	22.29	21.45	25	30	36	13	-	8	0.037
36-T5-15PB	6F	AL	15	23.88	23.05	28	30	36	16	6	10	0.041
36-T5-16PB	6F	AL	16	25.47	24.6	32	30	36	18	6	11	0.05
36-T5-18PB	6F	AL	18	28.65	27.8	32	30	36	19	6	12	0.061
36-T5-19PB	6F	AL	19	30.25	29.4	36	30	36	22	6	12	0.07
36-T5-20PB	6F	AL	20	31.83	31	36	30	36	23	6	14	0.76
36-T5-22PB	6F	AL	22	35.12	34.25	38	30	36	24	6	15	0.8
36-T5-24PB	6F	AL	24	38.21	37.4	42	30	36	26	6	15	0.109
36-T5-25PB	6F	AL	25	39.8	39	44	30	36	26	6	15	0.116
36-T5-26PB	6F	AL	26	41.47	40.6	44	30	36	26	6	16	0.12
36-T5-27PB	6F	AL	27	42.98	42.2	48	30	36	30	8	18	0.128
36-T5-28PB	6F	AL	28	44.62	43.75	48	30	36	32	8	18	0.135
36-T5-30PB	6F	AL	30	47.76	46.95	51	30	36	34	8	18	0.15
36-T5-32PB	6F	AL	32	50.94	50.1	54	30	36	38	8	22	0.176
36-T5-36PB	6F	AL	36	57.31	56.45	63	30	36	38	8	22	0.23
36-T5-40PB	6F	AL	40	63.66	62.85	66	30	36	40	8	23	0.273
36-T5-42PB	6F	AL	42	66.87	66	71	30	36	40	8	24	0.284
36-T5-44PB	6	AL	44	70.07	69.2	-	30	36	45	8	26	0.315
36-T5-48PB	6	AL	48	76.42	75.55	-	30	36	50	8	28	0.4
36-T5-60PB	6	AL	60	95.52	94.65	-	30	36	65	8	35	0.614

T5 & T10 Metric Timing Pulleys

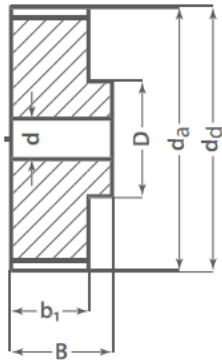

Type 6

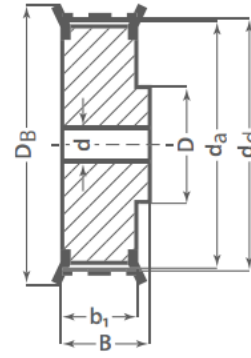

Type 6F

Part No.	Type	Material	No. of teeth	d(d)	d(a)	D(B)	b(1)	B (mm)	D (mm)	Pilot Bore d (mm)	Finished Bore hole (max)	Approx Kg
31-T10-12PB	6F	AL	12	38.2	36.35	42	21	31	28	6	16	0.076
31-T10-14PB	6F	AL	14	44.56	42.7	48	21	31	32	8	18	0.104
31-T10-15PB	6F	AL	15	47.75	45.9	51	21	31	32	8	18	0.116
31-T10-16PB	6F	AL	16	50.93	49.05	54	21	31	35	8	20	0.134
31-T10-18PB	6F	AL	18	57.29	55.45	60	21	31	40	8	22	0.167
31-T10-19PB	6F	AL	19	60.48	58.6	66	21	31	44	8	22	0.184
31-T10-20PB	6F	AL	20	63.66	61.8	66	21	31	46	8	24	0.208
31-T10-22PB	6F	AL	22	70.03	68.15	75	21	31	52	8	28	0.253
31-T10-24PB	6F	AL	24	76.39	74.55	83	21	31	58	8	30	0.288
31-T10-25PB	6F	AL	25	79.58	77.7	83	21	31	60	8	30	0.31
31-T10-26PB	6F	AL	26	82.76	80.9	87	21	31	60	8	30	0.357
31-T10-27PB	6F	AL	27	85.95	84.1	91	21	31	60	8	30	0.364
31-T10-28PB	6F	AL	28	89.13	87.25	93	21	31	60	8	30	0.401
31-T10-30PB	6F	AL	30	95.49	93.65	97	21	31	60	8	30	0.441
31-T10-32PB	6F	AL	32	101.86	100	106	21	31	65	10	32	0.493
31-T10-36PB	6F	AL	36	114.59	112.75	119	21	31	70	10	35	0.623
31-T10-40PB	6F	AL	40	127.32	125.45	131	21	31	80	10	40	0.767
31-T10-44PB	6	AL	44	140.06	138.2	-	21	31	88	10	46	0.993
31-T10-48PB	6	AL	48	152.78	150.95	-	21	31	95	16	48	1.09
31-T10-60PB	6	AL	60	190.98	189.1	-	21	31	110	16	60	1.71
40-T10-12PB	6F	AL	12	38.2	36.35	42	30	40	28	6	16	0.099
40-T10-14PB	6F	AL	14	44.56	42.7	48	30	40	32	8	18	0.134
40-T10-15PB	6F	AL	15	47.75	45.9	51	30	40	32	8	18	0.152
40-T10-16PB	6F	AL	16	50.93	49.05	54	30	40	35	8	20	0.176
40-T10-18PB	6F	AL	18	57.29	55.45	60	30	40	40	8	22	0.224
40-T10-19PB	6F	AL	19	60.48	58.6	66	30	40	44	8	22	0.247
40-T10-20PB	6F	AL	20	63.66	61.8	66	30	40	46	8	24	0.276
40-T10-22PB	6F	AL	22	70.03	68.15	75	30	40	52	8	28	0.337
40-T10-24PB	6F	AL	24	76.39	74.55	83	30	40	58	8	30	0.392
40-T10-25PB	6F	AL	25	79.58	77.7	83	30	40	60	8	30	0.422
40-T10-26PB	6F	AL	26	82.76	80.9	87	30	40	60	8	30	0.477
40-T10-27PB	6F	AL	27	85.95	84.1	91	30	40	60	8	30	0.536
40-T10-28PB	6F	AL	28	89.13	87.25	93	30	40	60	8	30	0.54
40-T10-30PB	6F	AL	30	95.49	93.65	97	30	40	60	8	30	0.64
40-T10-32PB	6F	AL	32	101.86	100	106	30	40	65	10	32	0.693

T5 & T10 Metric Timing Pulleys

Part No.	Type	Material	No. of teeth	d(d)	d(a)	D(B)	b(1)	B (mm)	D (mm)	Pilot Bore d (mm)	Finished Bore hole (max)	Approx Kg
40-T10-36PB	6F	AL	36	114.59	112.75	119	30	40	70	10	35	0.873
40-T10-40PB	6F	AL	40	127.32	125.45	131	30	40	80	10	40	1.067
40-T10-44PB	6	AL	44	140.06	138.2	-	30	40	88	10	46	1.35
40-T10-48PB	6	AL	48	152.78	150.95	-	30	40	95	16	48	1.516
40-T10-60PB	6	AL	60	190.98	189.1	-	30	40	110	16	60	2.339
47-T10-18PB	6F	AL	18	57.29	55.45	60	37	47	40	10	22	0.253
47-T10-19PB	6F	AL	19	60.48	58.6	66	37	47	44	10	22	0.286
47-T10-20PB	6F	AL	20	63.66	61.8	66	37	47	46	12	24	0.322
47-T10-22PB	6F	AL	22	70.03	68.15	75	37	47	52	12	28	0.393
47-T10-24PB	6F	AL	24	76.39	74.55	83	37	47	58	12	30	0.475
47-T10-25PB	6F	AL	25	79.58	77.7	83	37	47	60	12	30	0.527
47-T10-26PB	6F	AL	26	82.76	80.9	87	37	47	60	12	30	0.564
47-T10-27PB	6F	AL	27	85.95	84.1	91	37	47	60	12	30	0.602
47-T10-28PB	6F	AL	28	89.13	87.25	93	37	47	60	12	30	0.642
47-T10-30PB	6F	AL	30	95.49	93.65	97	37	47	60	12	30	0.74
47-T10-32PB	6F	AL	32	101.86	100	106	37	47	65	12	32	0.844
47-T10-36PB	6F	AL	36	114.59	112.75	119	37	47	70	16	35	1.083
47-T10-40PB	6F	AL	40	127.32	125.45	131	37	47	80	16	40	1.317
47-T10-44PB	6	AL	44	140.06	138.2	-	37	47	88	16	46	1.611
47-T10-48PB	6	AL	48	152.78	150.95	-	37	47	95	16	48	1.931
47-T10-60PB	6	AL	60	190.98	189.1	-	37	47	110	16	60	3.004
66-T10-18PB	6F	AL	18	57.29	55.45	60	56	66	40	10	22	0.422
66-T10-19PB	6F	AL	19	60.48	58.6	66	56	66	44	10	22	0.466
66-T10-20PB	6F	AL	20	63.66	61.8	66	56	66	46	12	24	0.52
66-T10-22PB	6F	AL	22	70.03	68.15	75	56	66	52	12	28	0.57
66-T10-24PB	6F	AL	24	76.39	74.55	83	56	66	58	12	30	0.736
66-T10-25PB	6F	AL	25	79.58	77.7	83	56	66	60	12	30	0.766
66-T10-26PB	6F	AL	26	82.76	80.9	87	56	66	60	12	30	0.816
66-T10-27PB	6F	AL	27	85.95	84.1	91	56	66	60	12	30	0.946
66-T10-28PB	6F	AL	28	89.13	87.25	93	56	66	60	12	30	0.96
66-T10-30PB	6F	AL	30	95.49	93.65	97	56	66	60	12	30	1.169
66-T10-32PB	6F	AL	32	101.86	100	106	56	66	65	12	32	1.3
66-T10-36PB	6F	AL	36	114.59	112.75	119	56	66	70	16	35	1.637
66-T10-40PB	6F	AL	40	127.32	125.45	131	56	66	80	16	40	1.999
66-T10-44PB	6	AL	44	140.06	138.2	-	56	66	88	16	46	2.357
66-T10-48PB	6	AL	48	152.78	150.95	-	56	66	95	16	48	2.83
66-T10-60PB	6	AL	60	190.98	189.1	-	56	66	110	16	60	4.366



WA HEAD OFFICE

Unit 1 / 45 Inspiration Drive WA 6065
 ☎ (08) 9303 4966 📠 (08) 9303 4977
 ✉ info@chainanddrives.com.au

NSW HEAD OFFICE

Unit 7 / 70 Holbeche Road Arndell Park NSW 2148
 ☎ (02) 9674 8611 📠 (02) 9674 8363
 ✉ salesnsw@chainanddrives.com.au

www.chainanddrives.com.au